

PolySto OP30F SaniCoat

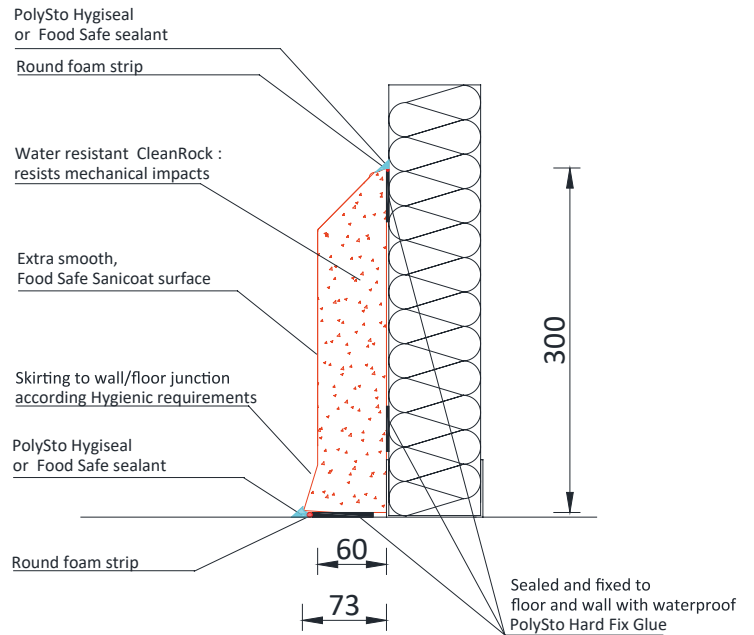

Protection level 3
Impact protection against
manual pallets

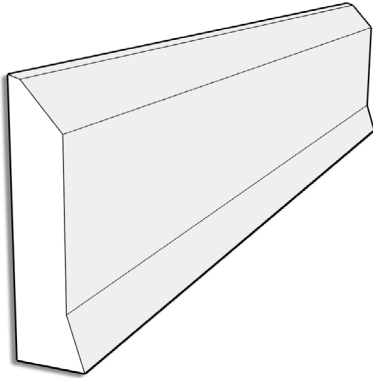

Specification

PolySto OP30F SaniCoat is a prefabricated full core kerb 1500x60x300mmH with sloped top and skirting to wall-floor according hygienic requirements. The OP30F SaniCoat kerb consists of a water repellent durable CleanRock mass and the surface is finished Food Safe with a smooth SaniCoat (Polyester gelcoat). Including matching accessories; prefabricated internal and external corners and endpieces.

Waterproof bonding using PolySto Hard Fix Glue (Hybrid Polymere). Finishing of the joints using PolySto Food Safe Sealant or a chemical welding HygiSeal.

Consumption

Consumption Food Safe sealant (per meter)

| | |
|---|----------|
| Food Safe sealant white | 200 cc |
| Food Safe sealant transparent | 150 cc |
| Hard Fix Glue | 450 cc |
| Installation m/day (8h) with 2 installers | 60 meter |

Consumption HygiSeal (per meter)

| | |
|---|----------|
| HygiSeal white | 150 cc |
| Hard Fix Glue | 450 cc |
| Installation m/day (8h) with 2 installers | 40 meter |

Technical info

| | Kerb | Corner internal / external | End piece right / left |
|-----------------|--------------|----------------------------|------------------------|
| Length | 1.500 mm | 2 x 500 mm | 500 mm |
| Height | 300 mm | 300 mm | 300 mm |
| Thickness | 60 mm | 60 mm | 60 mm |
| Weight | 57,80 kg | 38,50 kg | 19,25 kg |
| Amount / pallet | 30 m | 20 pc | 20 R & 20 L |
| Pallet size | 155x65x70cmH | 120x80x70cmH | 120x80x70cmH |
| Pallet weight | +/- 1.170 kg | +/- 790 kg | +/- 790 kg |

Kerb

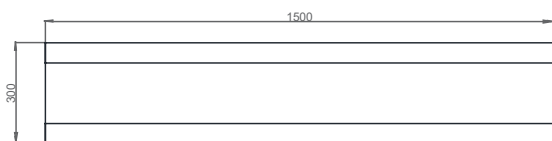

Internal corner

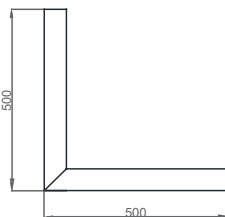

External corner

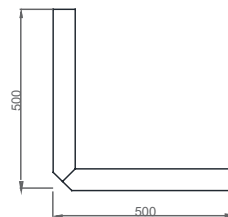

End piece

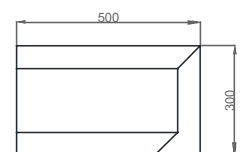

POLYSTO BVBA

CONTACT

Maesbossen 3
9160 Lokeren
Belgium

T. +32 9 33 77 660
E. info@polysto.com
www.polysto.com

Soon available for **BIM** (Building information modeling)