

## PolySto CleanRock® kerbs

### Next-generation CleanRock® kerbs

CleanRock® is PolySto's engineered core material for hygienic kerbs, developed to **deliver long-term wall protection** in demanding food-processing environments. Manufactured from a high-performance composite of polyester resins, quartz granules and additives, CleanRock® kerbs combine very **high impact resistance** with a non-porous, water-tight structure.

CleanRock® kerbs are supplied as a modular, prefabricated system. The range includes matching internal and external corners, as well as door end pieces. As standard, CleanRock® kerbs are delivered in a natural finish. A SaniCoat finish for exceptional chemical resistance is available on request. SaniCoat is a factory-applied protective coating that further enhances surface smoothness and cleanability.

- **SUSTAINABLE**  
New composition with recycled fiberglass material for an eco-friendly solution.
- **DURABLE**  
Built to last — 10x stronger than concrete.
- **LIGHTWEIGHT**  
Slim, easy to handle for faster installation.
- **QUICK TO INSTALL**  
Modular and prefabricated system.
- **EASY TO CLEAN**  
Food-safe design to wash away dirt quickly from walls.

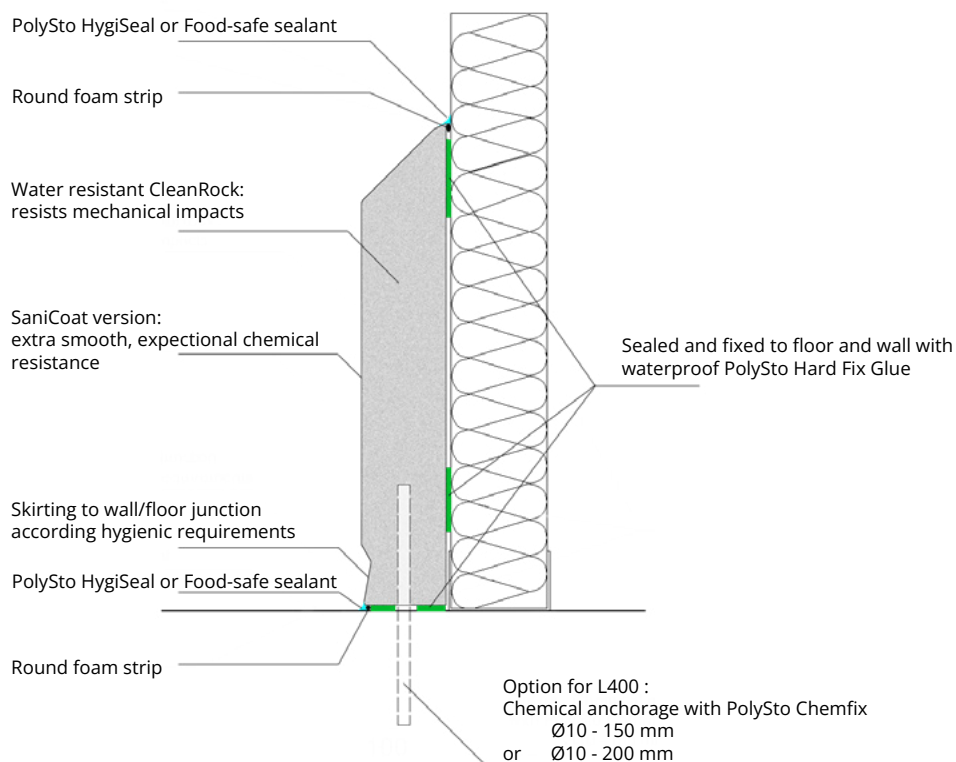
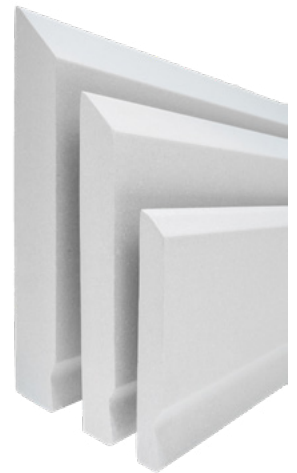

## L400



### IMPACT LEVEL 4

Electric pallet trucks with total loads up to 1500 Kg.



### IMPACT LEVEL 5, when kerbs are installed using chemical anchorage

Engine-driven pallet trucks with total loads up to 4000 Kg, maximum speed 5 km/h.

### Technical info

	Kerb	Internal corner	External corner	End piece right / left
Length	1.500 mm	2 x 575 mm	1.030 mm	1.150 mm
Height	400 mm	400 mm	400 mm	400 mm
Thickness	70 mm	70 mm	70 mm	70 mm
Weight	78,9 kg	2 x 28,95 kg	57 kg	57,8 kg
Amount / pallet	16 pcs	16 pcs (sets)	16 pcs	16 pcs
Pallet size	155 x 65 x 70cmH	120 x 80 x 70cmH	120 x 80 x 70cmH	120 x 80 x 70cmH
Pallet weight	± 1275 kg	± 955 kg	± 940 kg	± 950 kg
Temperature resistance	-35°C - +85°C (long exposure)			

### Average consumption of

Food-safe Sealant or HygiSeal white or RAL9002	350 cc / meter
Hard Fix Glue	650 cc / meter
Chemfix	70 cc / drilling

### Installation m/day (8h) with 2 installers

Food-safe Sealant	30 meter
HygiSeal	20 meter

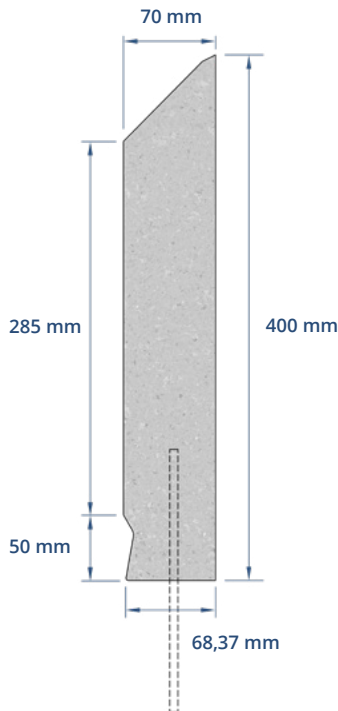

Optional: chemical anchorage of  $\varnothing 10$  - 150 mm or 200 mm with PolySto 2-component Chemfix.  
back rebate (20 mm deep x 60 mm high) possible WITHOUT anchorage

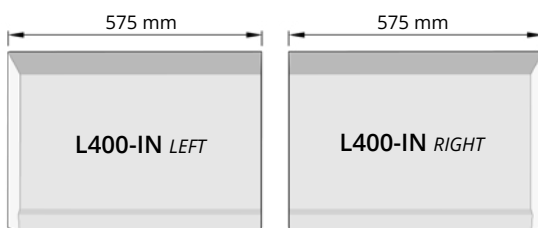
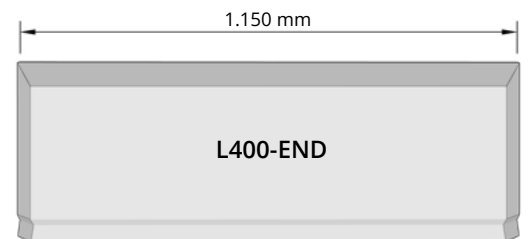

Internal corners are always supplied in sets.

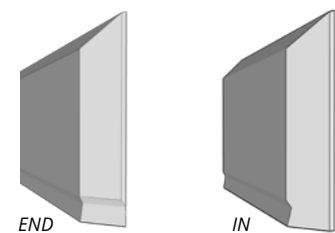

difference between END and IN

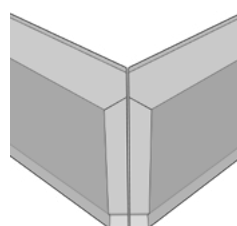

installed L400-EX

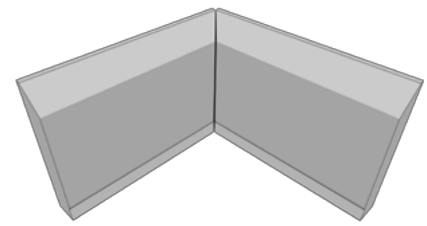

installed L400-IN

## Description

CleanRock® is the **patented core material** used in PolySto kerbs. The composition has been developed based on more than 30 years of experience in the food processing industry.

**Prefabricated** CleanRock® kerbs are composed of a mixture of polyester resins, quartz granulates and additives. The unique composition allows to prevent contaminations with Salmonella and Listeria. **CleanRock®** contains recycled FRP (CleanSheet) from our own production process, contributing to additional structural strength. CleanRock is ideal for food safe environments that have to comply with HACCP, EU, USDA, GFSI (Global Food Safety Standard Initiative), BRC and other food safety standards



**Food  
safe**



**Chemical  
resistant**



**Water  
resistant**



**Damage  
resistant**



**Strong**

## Properties

### No water absorption

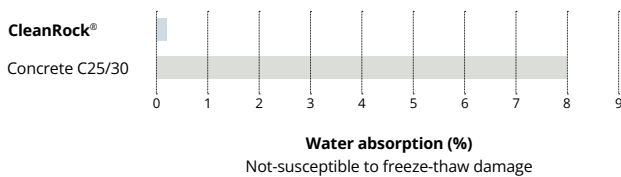

### 10x stronger than concrete

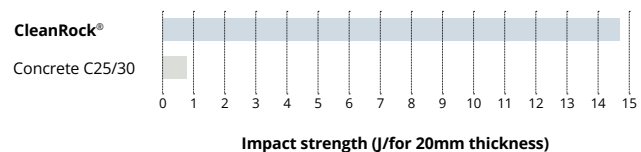

### Flexural strength (MPa)

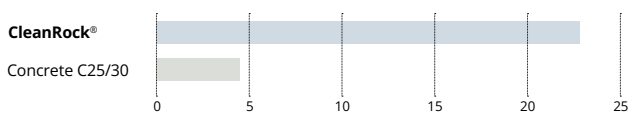

### Compressive strength (MPa)

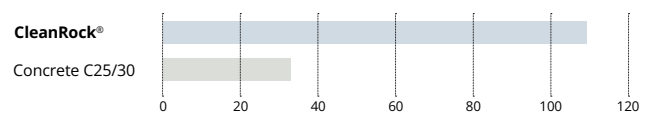

Essential characteristics	Performance	Conform
Water absorption	0,2 %	NBN B15-215
Impact strength	14,7 J	EN 14617-9
Flexural strength	22,83 MPa	EN 196-1
Compressive strength	110,24 Mpa	EN 196-1
Volumetric mass	2.050 kg/m <sup>3</sup>	
Fire behavior	B,s2-d0	

High chemical resistance

The product design complies with EHEDG guidelines.

