

PolySto CleanRock® kerbs

Next-generation CleanRock® kerbs

CleanRock® is PolySto's engineered core material for hygienic kerbs, developed to **deliver long-term wall protection** in demanding food-processing environments. Manufactured from a high-performance composite of polyester resins, quartz granules and additives, CleanRock® kerbs combine very **high impact resistance** with a non-porous, water-tight structure.

CleanRock® kerbs are supplied as a modular, prefabricated system. The range includes matching internal and external corners, as well as door end pieces. As standard, CleanRock® kerbs are delivered in a natural finish. A SaniCoat finish for exceptional chemical resistance is available on request. SaniCoat is a factory-applied protective coating that further enhances surface smoothness and cleanability.

- **SUSTAINABLE**
New composition with recycled fiberglass material for an eco-friendly solution.
- **DURABLE**
Built to last — 10x stronger than concrete.
- **LIGHTWEIGHT**
Slim, easy to handle for faster installation.
- **QUICK TO INSTALL**
Modular and prefabricated system.
- **EASY TO CLEAN**
Food-safe design to wash away dirt quickly from walls.

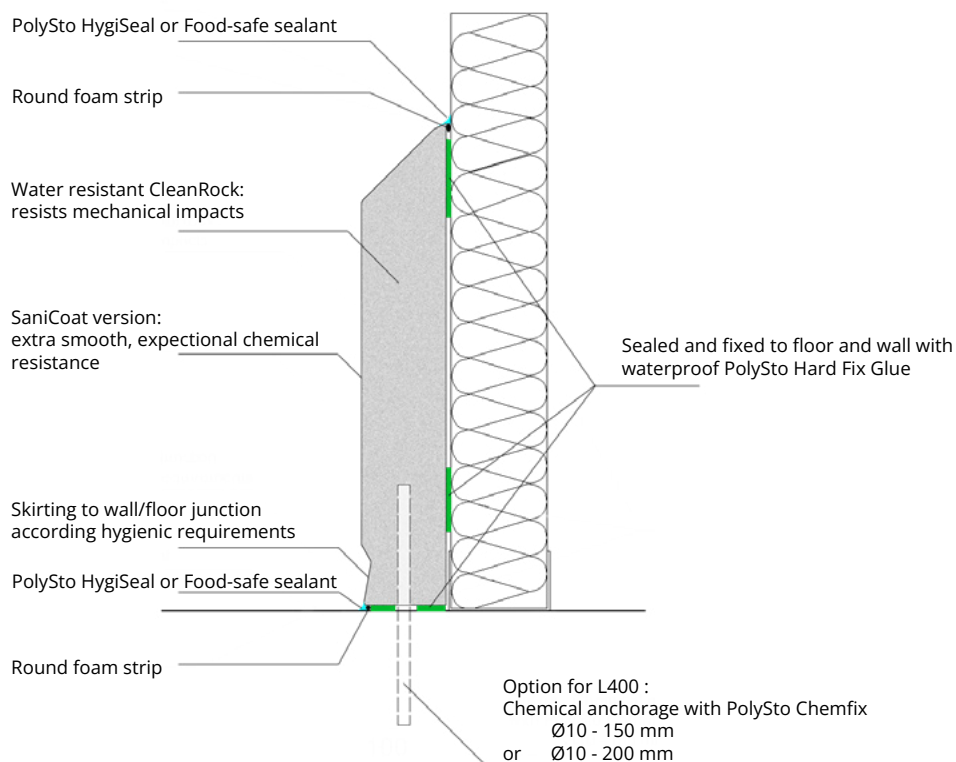
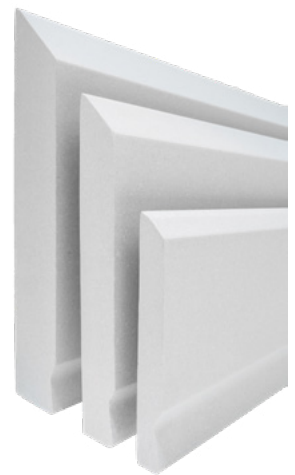

M300



IMPACT LEVEL 3

Manual pallet trucks with total loads up to 900 Kg.

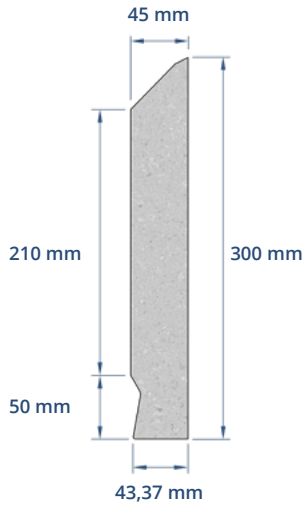

Technical info

	Kerb	Internal corner	External corner	End piece right / left
Length	1.500 mm	2 x 575 mm	1.080 mm	1.150 mm
Height	300 mm	300 mm	300 mm	300 mm
Thickness	45 mm	45 mm	45 mm	45 mm
Weight	38,3 kg	2 x 14,35 kg	28 kg	28,7 kg
Amount / pallet	24 pcs	24 pcs (sets)	24 pcs	24 pcs
Pallet size	155 x 65 x 70cmH	120 x 80 x 70cmH	120 x 80 x 70cmH	120 x 80 x 70cmH
Pallet weight	± 930 kg	± 715 kg	± 700 kg	± 710 kg
Temperature resistance	-35°C - +85°C (long exposure)			

Average consumption of

Food-safe Sealant or HygiSeal white or RAL9002	290 cc / meter
Hard Fix Glue	450 cc / meter

Installation m/day (8h) with 2 installers

Food-safe Sealant	40 meter
HygiSeal	30 meter

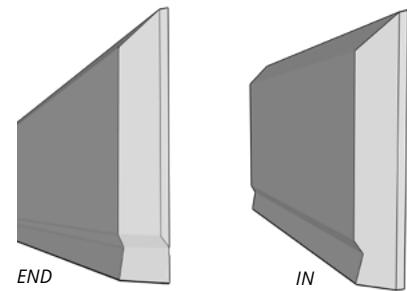
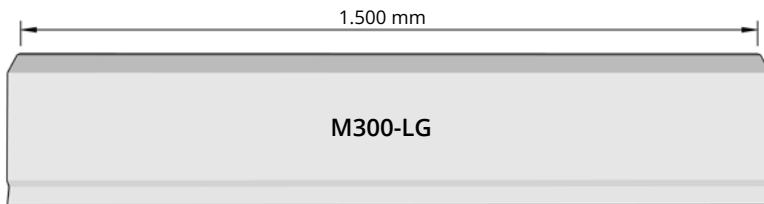

difference between END and IN

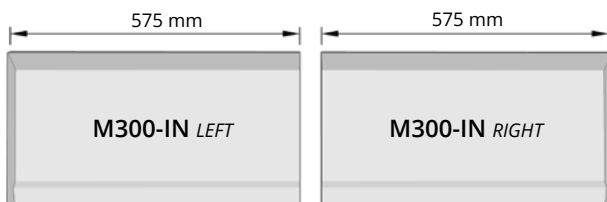

Internal corners are always supplied in sets.

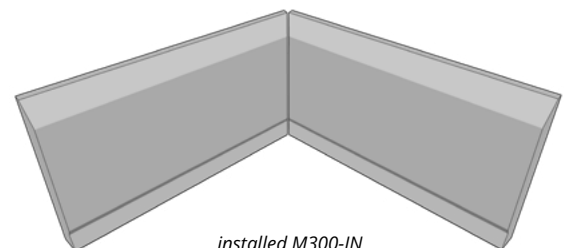

installed M300-IN

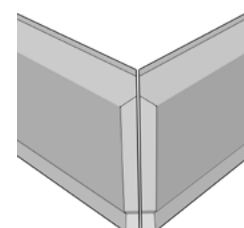
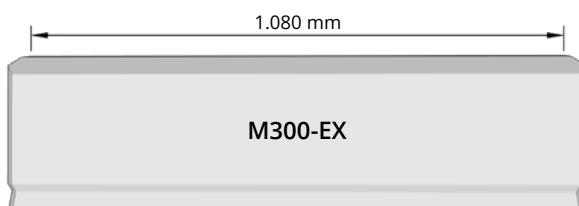

installed M300-EX

Description

CleanRock® is the **patented core material** used in PolySto kerbs. The composition has been developed based on more than 30 years of experience in the food processing industry.

Prefabricated CleanRock® kerbs are composed of a mixture of polyester resins, quartz granulates and additives. The unique composition allows to prevent contaminations with Salmonella and Listeria. **CleanRock®** contains recycled FRP (CleanSheet) from our own production process, contributing to additional structural strength. CleanRock is ideal for food safe environments that have to comply with HACCP, EU, USDA, GFSI (Global Food Safety Standard Initiative), BRC and other food safety standards



Food safe



Chemical resistant



Water resistant



Damage resistant



Strong

Properties

No water absorption

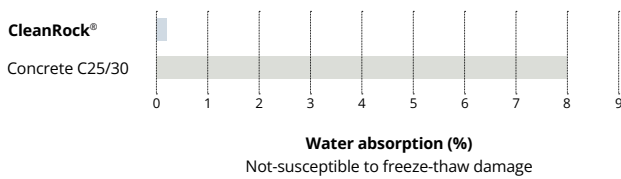

10x stronger than concrete

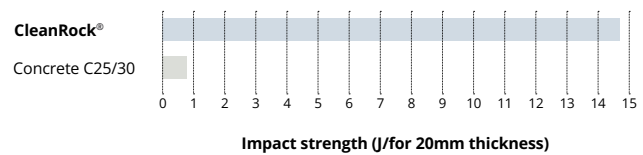

Flexural strength (MPa)

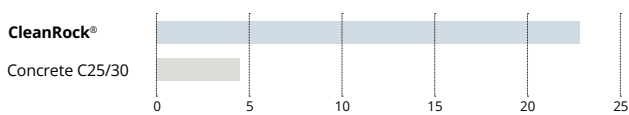

Compressive strength (MPa)

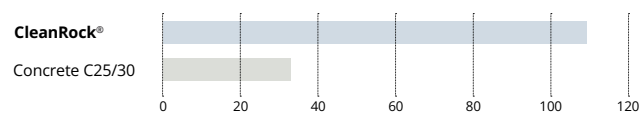

Essential characteristics	Performance	Conform
Water absorption	0,2 %	NBN B15-215
Impact strength	14,7 J	EN 14617-9
Flexural strength	22,83 MPa	EN 196-1
Compressive strength	110,24 Mpa	EN 196-1
Volumetric mass	2.050 kg/m ³	
Fire behavior	B,s2-d0	

High chemical resistance

The product design complies with EHEDG guidelines.

